

DYNEX
PALLISIDE®

Traditional Profile Joinery Facings

INSTALLATION GUIDE





The Palliside® facing system consists of decorative trims installed around openings to create a traditional aesthetic. The following provides an overview of components used.

CONTENTS

1.0 Component Overview	2
2.0 Head Flashings	2
3.0 Facing Fixings	2
4.0 Facing Bases	3
5.0 Under Joinery Finishing	4
6.0 Facings Caps	6
7.0 Finishing	8

1.0 Component Overview

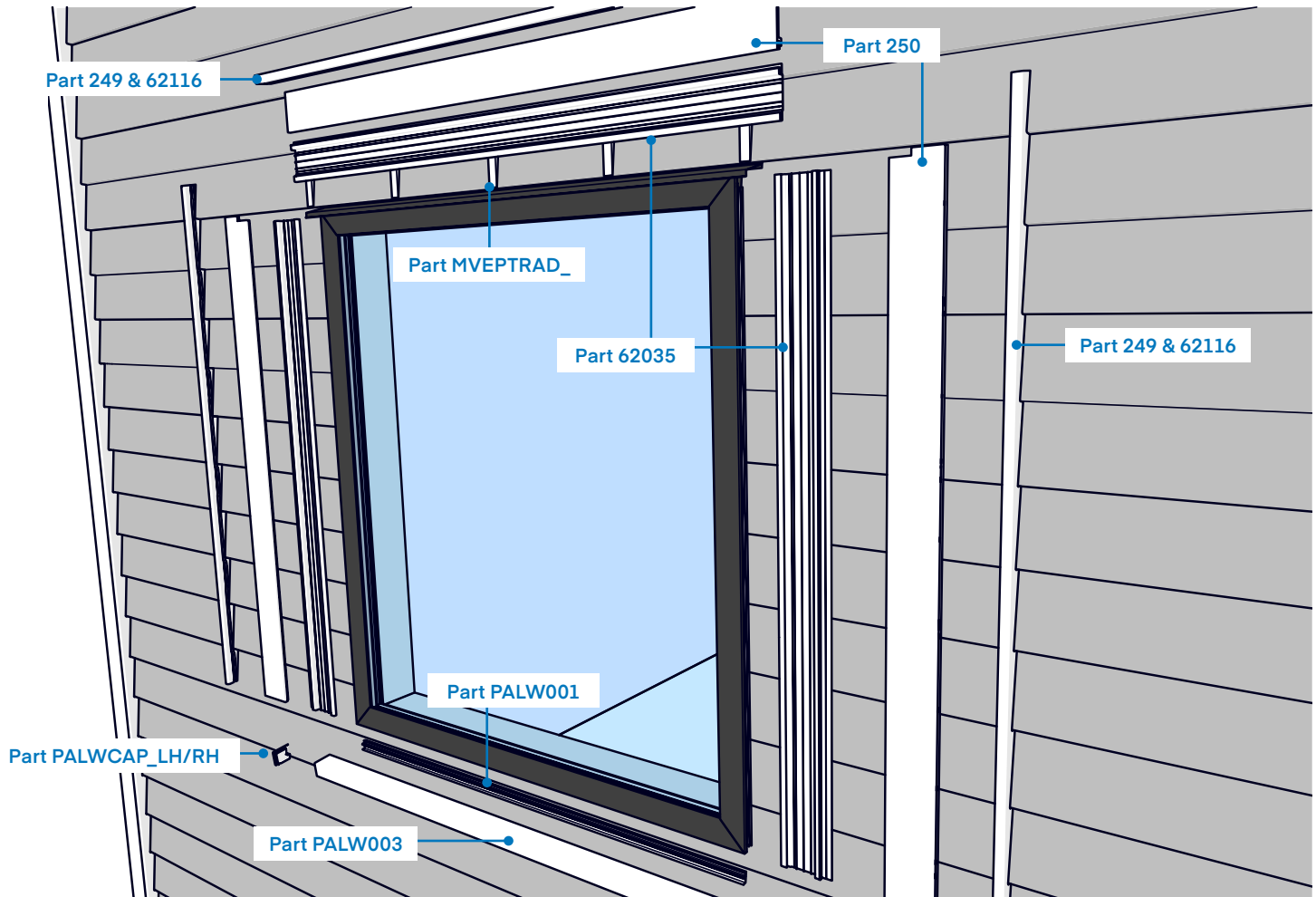

2.0 Head Flashings

Ensure head flashings are carried min. 20mm past joinery each side at head before installing joinery facings.

3.0 Facing Fixings

It is recommended that the Palliside® facings componentry is fixed using class 4 or above exterior grade 8Gx20 pan head screws.

The facing head is permanently fixed using 19mm VHB foam tape 5962.

Scribers are fixed using solvent glue or MS Polymer.

Details on fixings for all other standard Palliside® componentry can be found in the relevant Palliside® installation guide.

4.0 Facing Bases

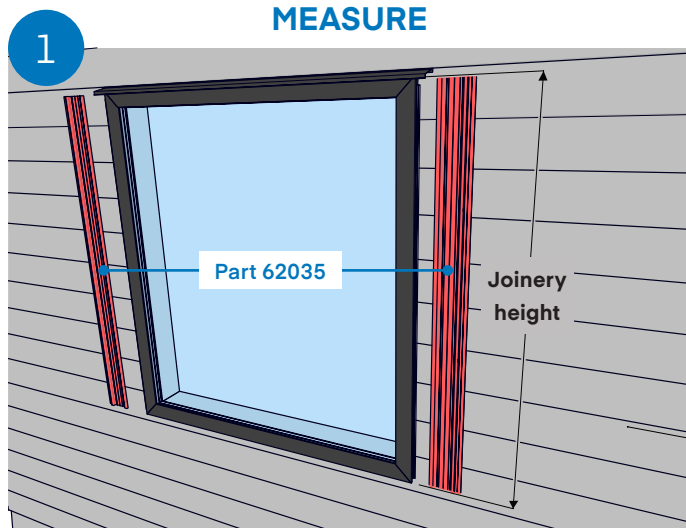

- › Measure joinery flange height
- › Cut 2 x facing bases for left and right hand sides to match
- › Check fit against joinery

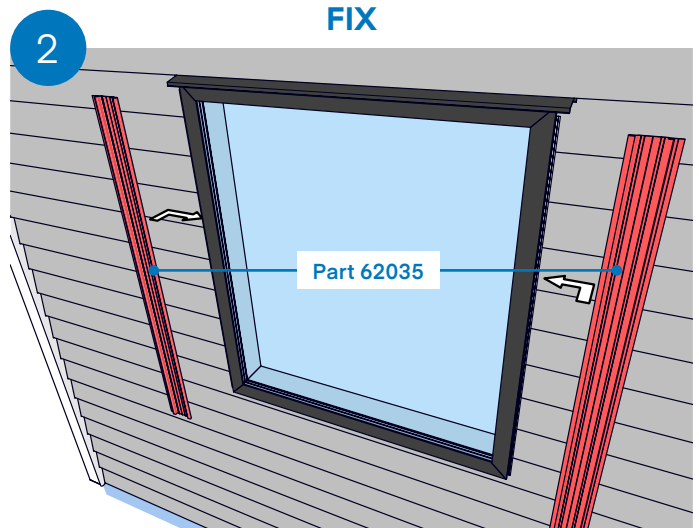

- › Position bases each side of joinery hard against joinery jamb

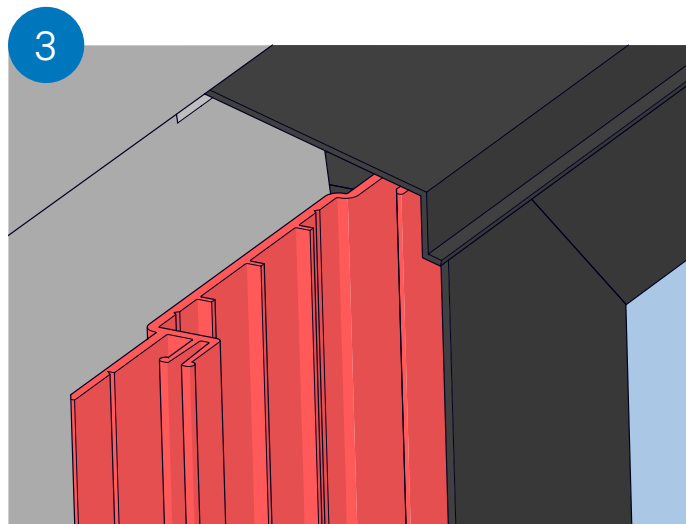

Note:
Correct handed orientation (scriber flange and clip away from joinery)

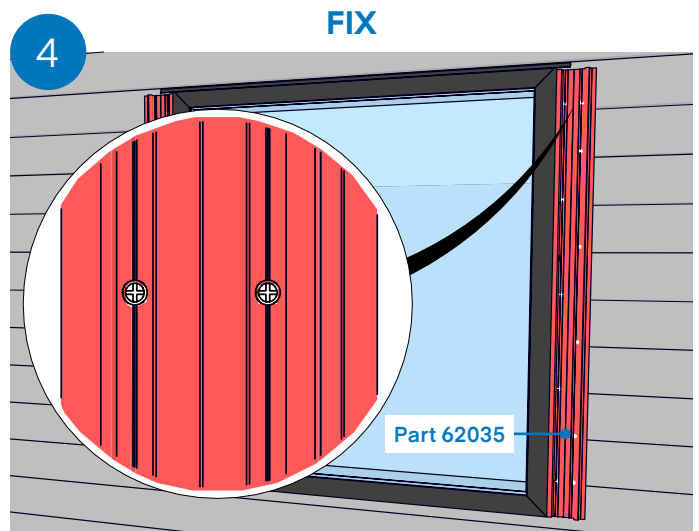

- › Fix into peaks of Palliside® traditional profile using Class 4 8Gx20 pan head screws

MEASURE

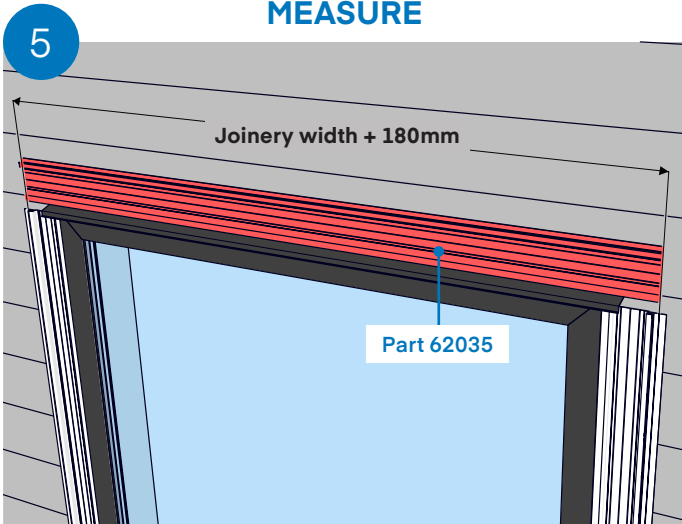

- › Cut and fit facing base for the top cap to dimension above

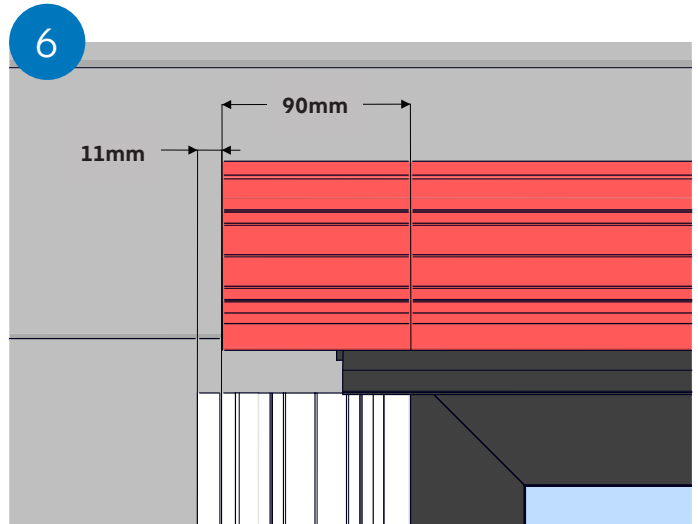

- Note:**
Allow clearance for scribers shown above

TRIM

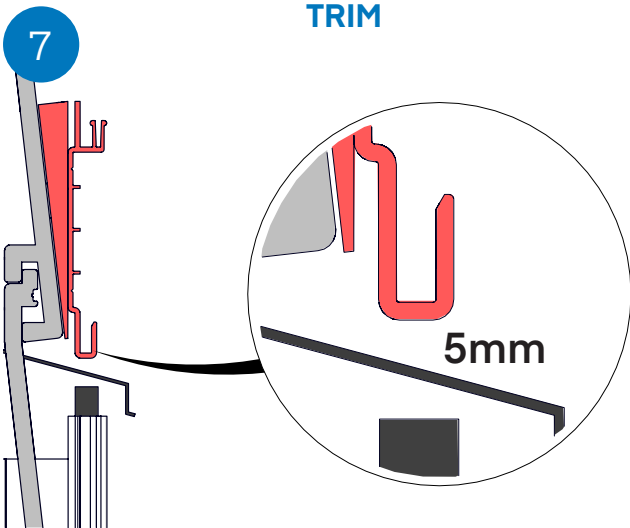

Note:
Orientation of base

- › Tear off scribe flange (to accommodate the facing head later)
- › Position base 5mm above the joinery flashing
- › Cut Palliside® end plugs (used as wedges) under-flush to the top edge of the torn facing base

FIX

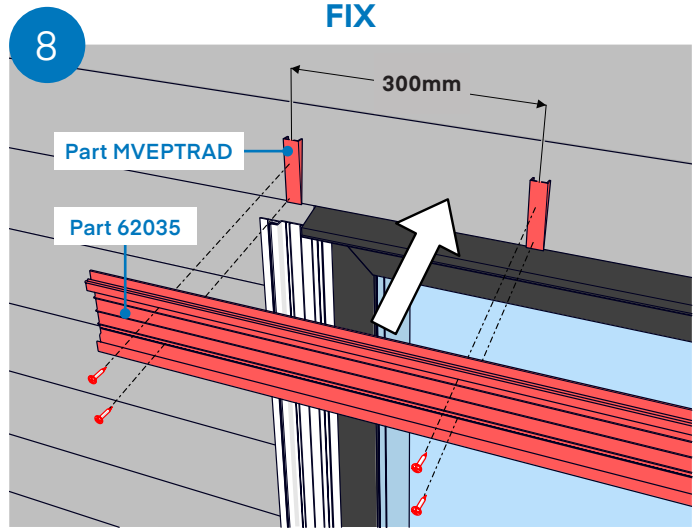

- › Position wedges spaced apart by 300mm to support head base
- › Fix through both the base and wedge packers into the Palliside®

- Note:**
It helps to hold the wedges in place using thin double-sided tape.

5.0 Under Joinery Finishing

The full planted sill is used below windows to complete the facings finish. The full planted sill is not to be used under doors or ranch sliders. The under-window bead is used in these applications, which uses the same base, with Part PALW002 installed over.

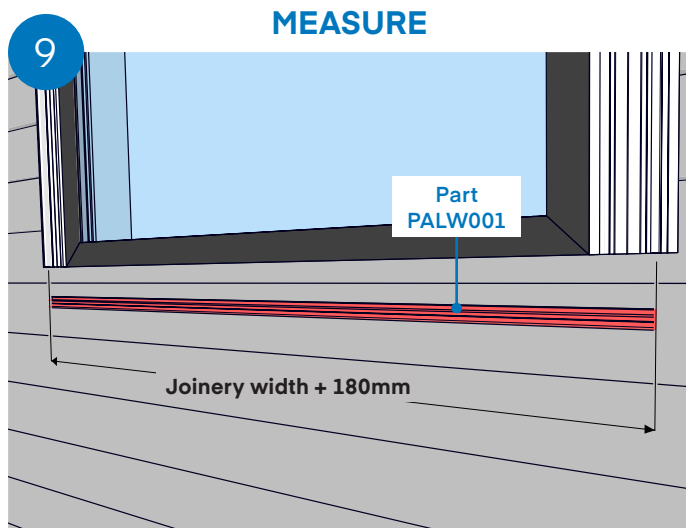

- › Cut Palliside® under window base clip to fit

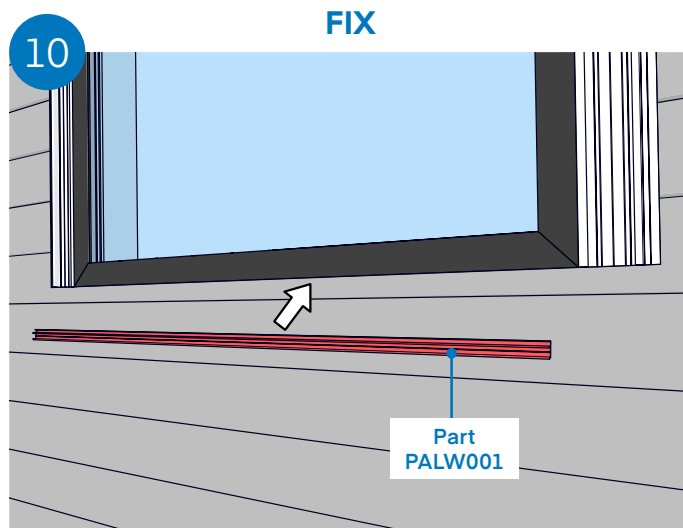

- › Fix base in place directly below joinery through the fixing groove using class 4 or above 8Gx20 pan head screws at 300mm centres

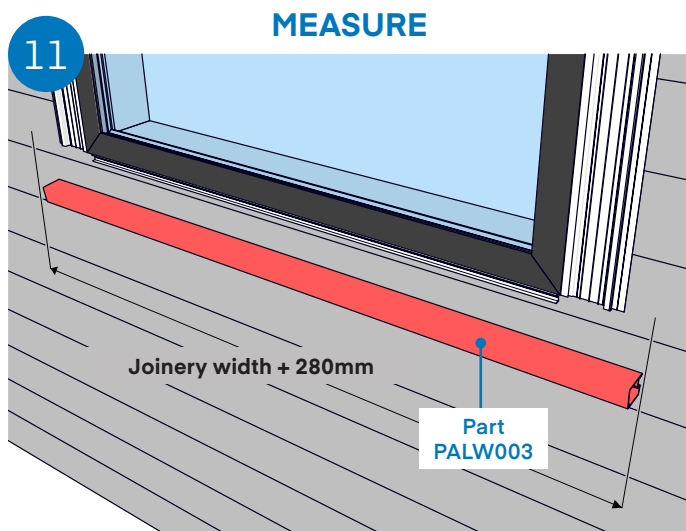

Note:

For windows only. Doors and ranch sliders to be finished with the under-window bead (part PALW002).

- › Cut the under window planted sill to size allowing for scribe width + overhang (50mm per side suggested)
- › Modify sill by removing snap-off tab if the sill sits fully on the flat section of board profile)

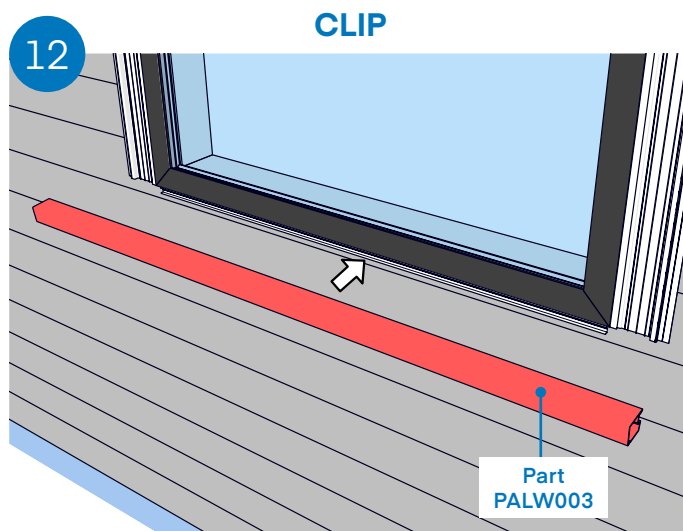

Note:

Ensure central to window before clipping in place.

- › Clip the sill firmly in place over the window base clip ensuring that the clip is fully engaged
- › Fix sill at one side of joinery (inside the sill) to avoid movement

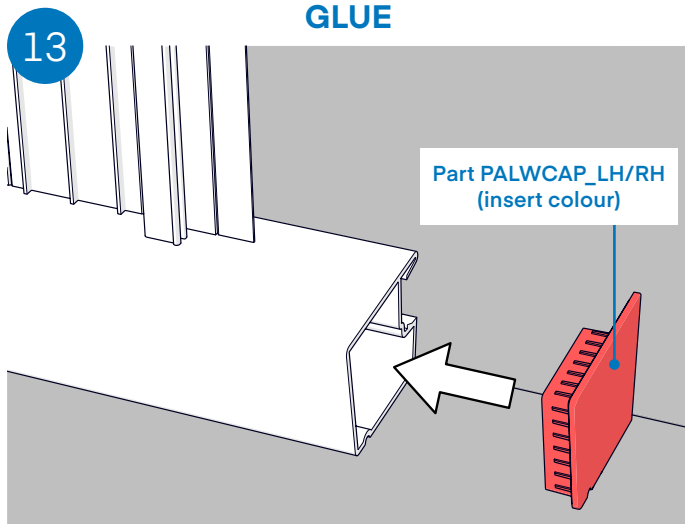

- › Modify handed sill caps if required (by removing extension tabs) to fit against weatherboard profile

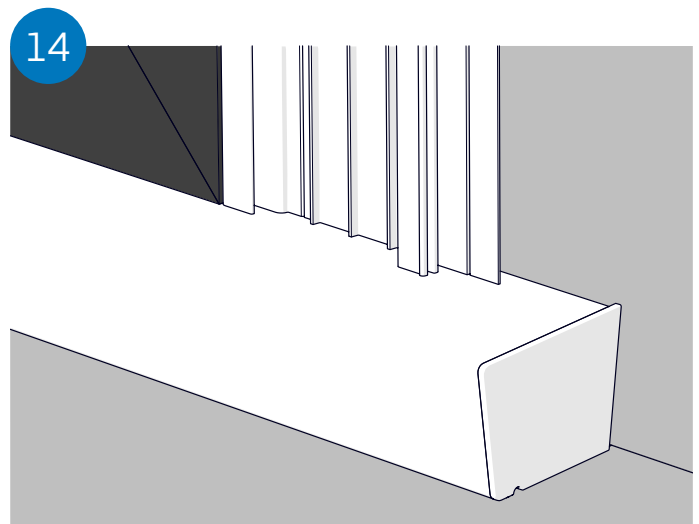

- › Glue caps each side to sill ends using solvent cement

6.0 Facing Caps

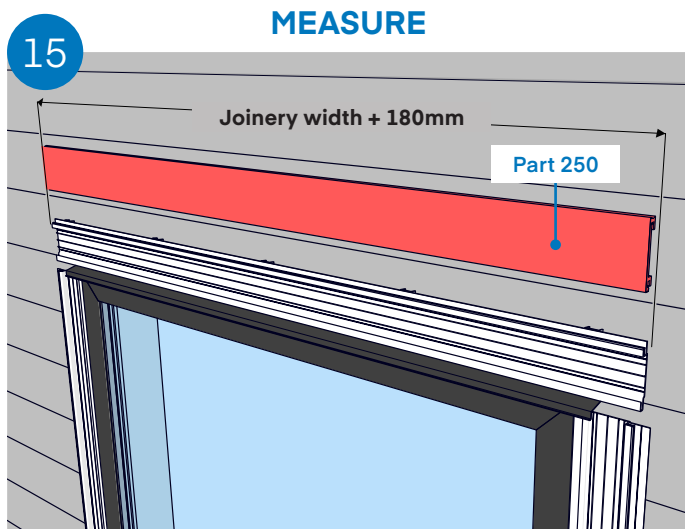

- › Measure and cut facing cap for head

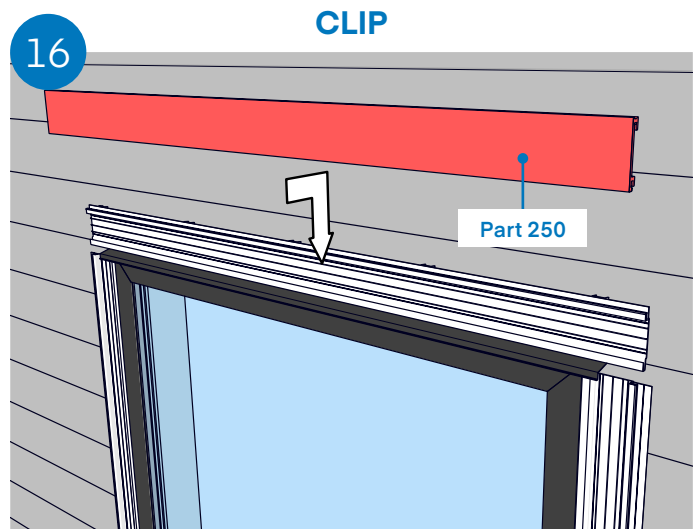

- › Push and slide the facing cap firmly down onto the base to engage the clip

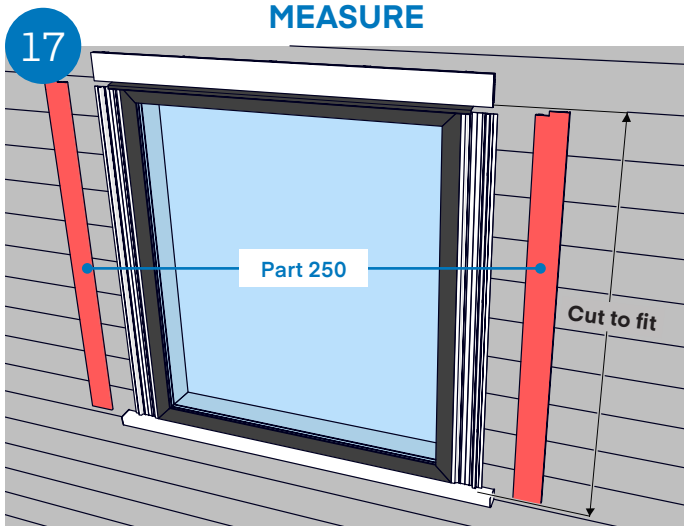

- › Measure and cut left and right facing caps carefully to fit snug between the head facing and sill

Note:

Notch facings to fit around head flashing.

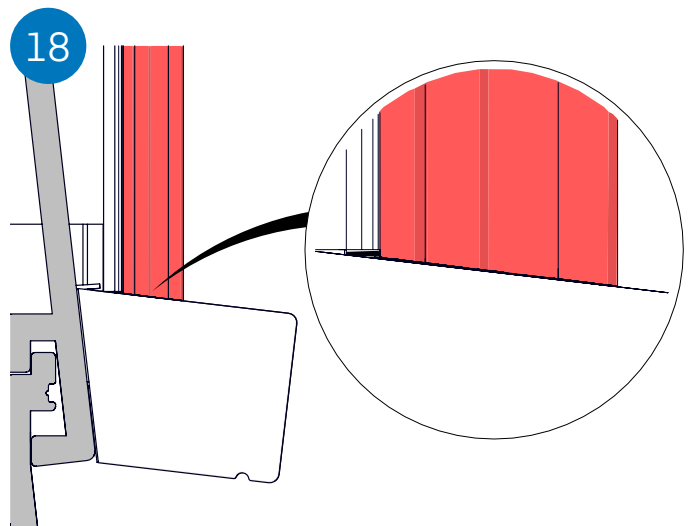

- › Cut bottom edge to facing caps to match sill angle

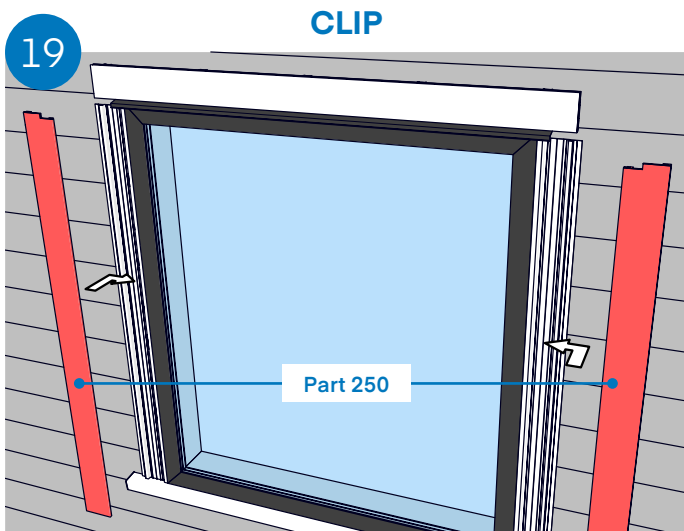

- › Push and slide the facing caps firmly over the bases to lock into place

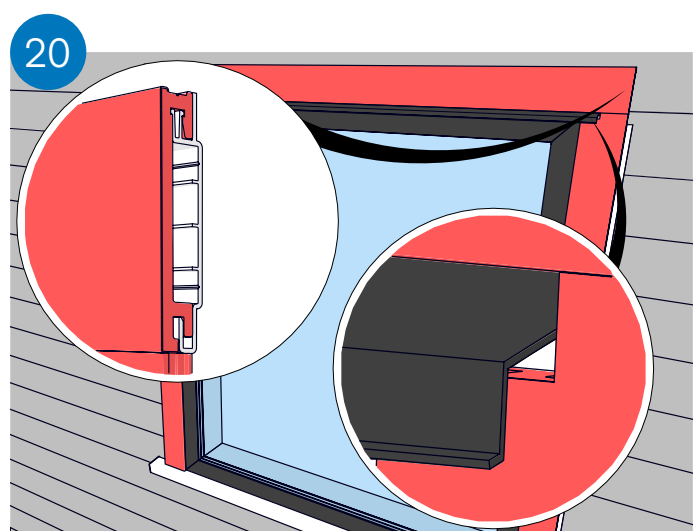

- › Ensure all facings caps are fully engaged into facing bases

7.0 Finishing

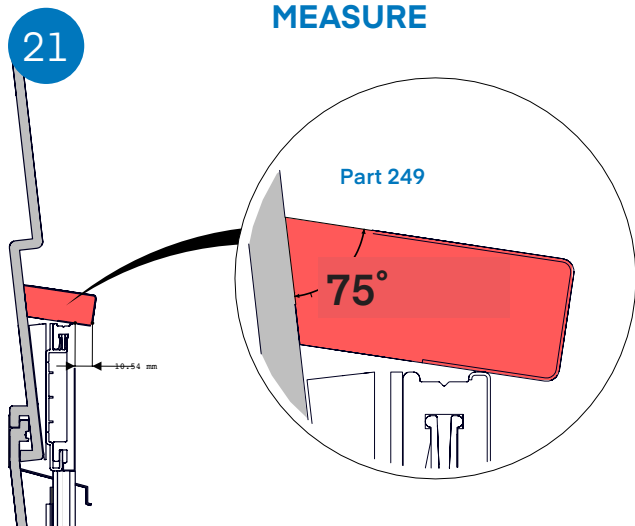

- › Measure and cut facing head angle
- › Clean and dry the surface directly above head facing cap using isopropyl alcohol or white spirits

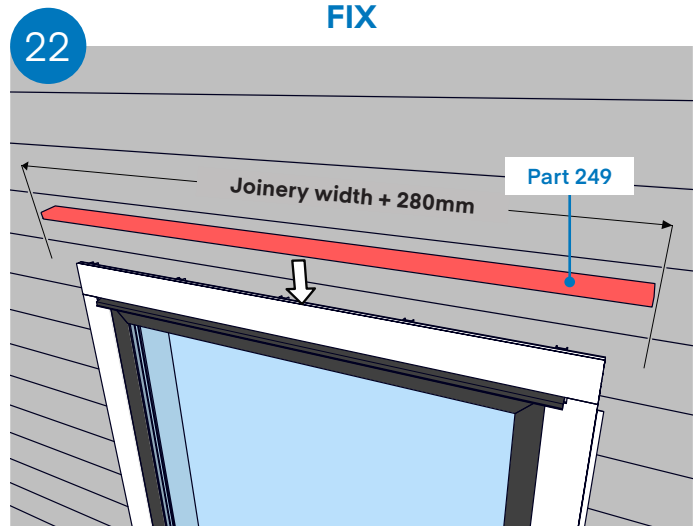

- › Measure and cut facing head to length
- › Apply 19mm 3M VHB tape 5962 along cut edge of the head
- › Position the head in place and slowly peel away the tape lining while firmly pressing down on facing head to ensure good adhesion

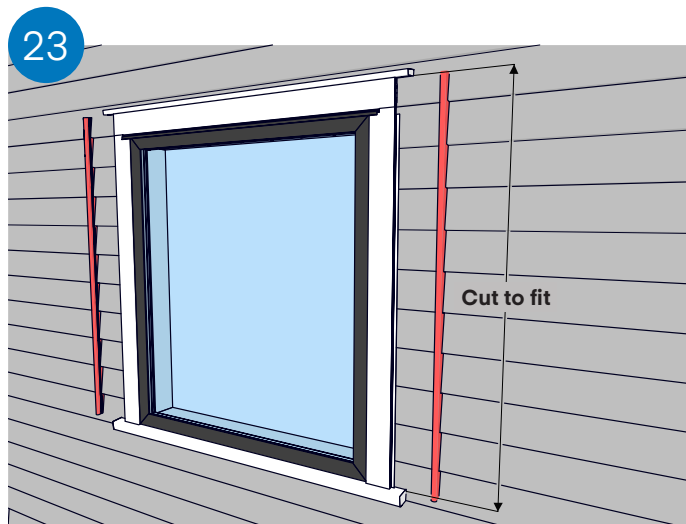

Measure and cut scribes.

- › Hold scribe firmly in place. Mark and cut to match angle at head and angle at sill

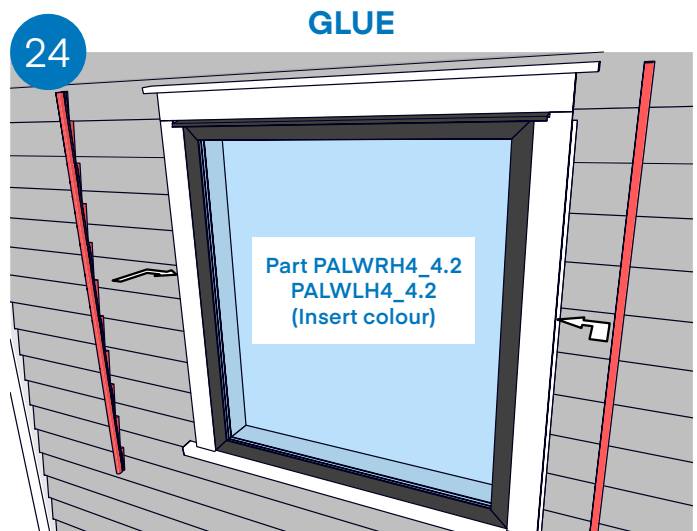

- › Apply a continuous bead of solvent cement to the scribe groove
- › Install into place, pressing firmly towards joinery and up against the board profile to ensure a good bond

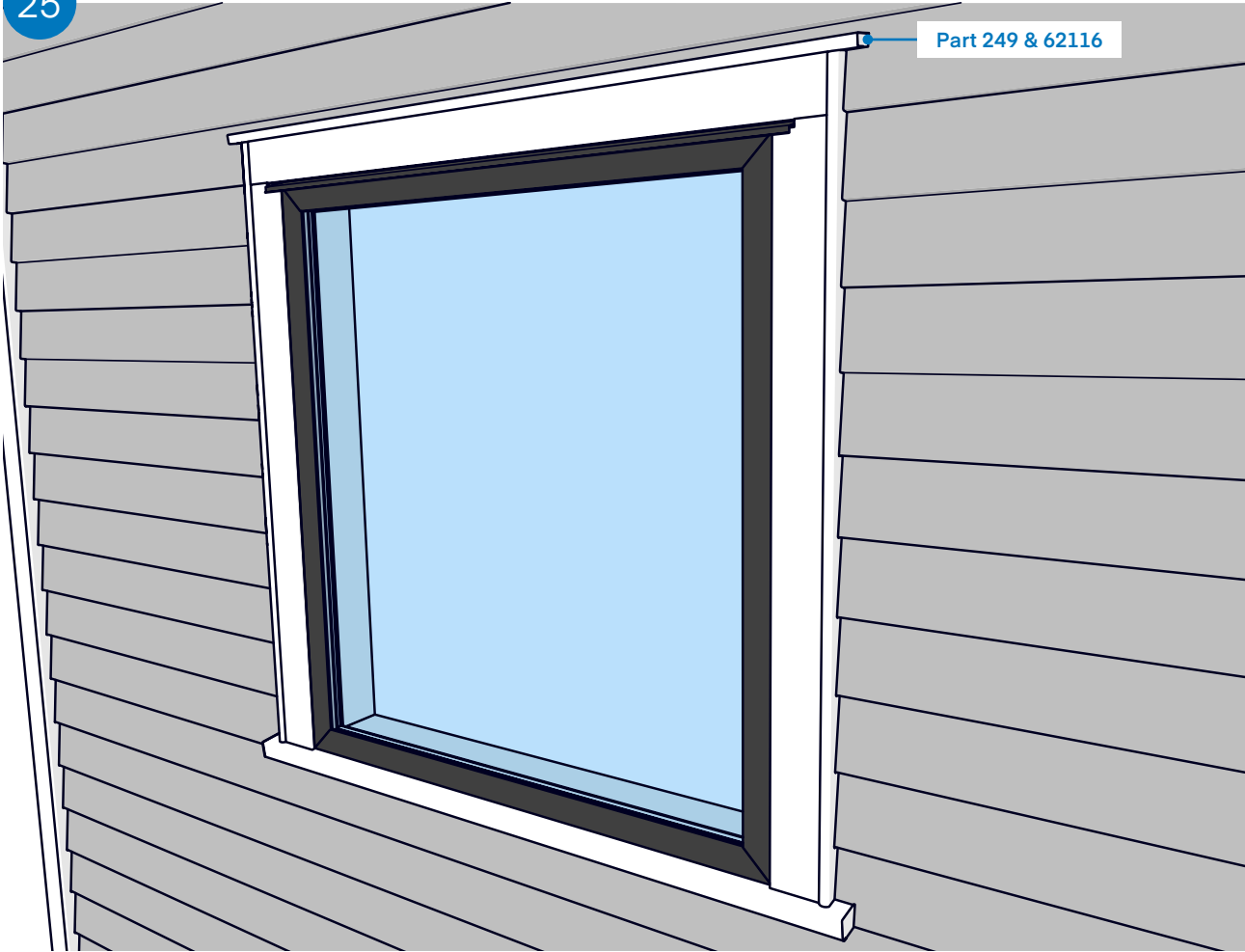
**Note:**

Trim the facing head ends to the correct shape and glue into place each side of facing head using MS or solvent glue.



Contact Details

For further information visit the website palliside.co.nz or alternatively contact:
DYNEX EXTRUSIONS LTD PO BOX 19-133, Avondale 1746, Auckland, New Zealand.

Freephone 0800 439 639

All material contained within this document is copyright ©2024 Dynex Extrusions Ltd.
No part thereof may be reproduced without the permission of Dynex Extrusions Ltd.

Building towards a better tomorrow

The environmental impact of our daily choices is an important consideration for Dynex. We are committed to supplying products and services that are in accordance with the principles of environmental sustainability. Dynex PALLISIDE® is made from 100% recyclable material. We have a policy of recycling all internally-generated scrap material so that nothing is sent to landfill.

Dynex has a goal to reach 100% renewable electricity by 2025 by leveraging Meridian Energy's Certified Renewable Energy programme.



DYNEX
PALLISIDE®

0800 439 639 | palliside.co.nz

alixis